



IT ROLLS! IT FOLDS! IT LIGHTS UP!

Smart Bar 5L Dimensions:

Open 60 1/4"W x 31 1/4"D x 48"H
Closed 60 1/4"W x 10 3/4"D x 55 3/4"
200 lbs.

1. Unbreakable translucent high impact panels are easy to remove. Add customized panels in front & sides (also removable) for branding, marketing, matching décor...
2. Choose black or white bar top counter.
3. Constructed of lightweight, sturdy metal in black or white (custom colors special order).
4. Integrated wheel covers are attached and fold giving the bar an elegant look.
5. Adjustable rubber nibs support top counter height.
6. Full shelf folds with the bar and provides storage space.
7. Two professional integrated removable cutting boards.
8. Two large, removable ice bins.
9. Panels remove easily from the inside of the bar rather than the outside giving the bar a clean & elegant look.
10. Convenient Speed Well holds 18 bottles.
11. Heavy duty stabilizer bars provide room for extra supplies & fold with the bar.
12. SmartBar folds flat to less than 12 inches and rolls easily for storage.
13. Bar top is attached and folds with the bar.
14. Front & rear casters for maximum stability & safety - easy to roll the bar when open, loaded or folded closed.
15. Fully integrated, battery-operated, remote-controlled, water resistant multi-color LED lighting & effects.
16. Optional rechargeable battery eliminates the need for wires.

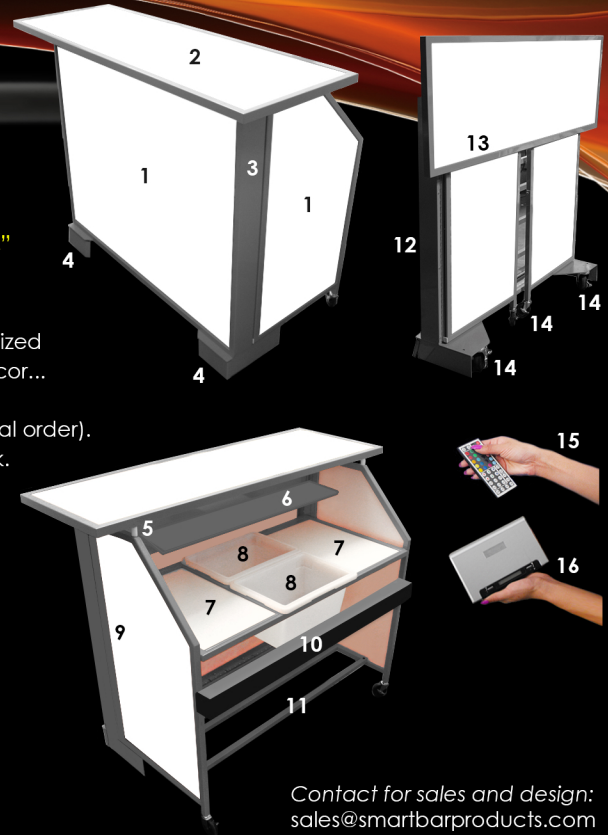

Contact for sales and design:
sales@smartbarproducts.com
shelly@smartbarproducts.com
www.smartbarproducts.com
877-777-2441